



SIMPLY HOMES

Windsor Drive

Hertford SG14 2HU

Price Guide £375,000



Windsor Drive

Hertford SG14 2HU

A well proportioned and presented three bedroom terraced property perfectly located within walking distance to Hertford North Station and local amenities.

On the ground floor there is a square living room with front aspect double glazed window and leads through to the kitchen/diner. The kitchen comprises of a range of base and eye level units, integrated appliances, a rear aspect double glazed window and door leading to the garden.

To the first floor landing, there are two double bedrooms and a third bedroom as well as 3-piece family bathroom.

The exterior consists of a delightful sunny rear garden, perfect for all entertainment needs. Predominantly laid to lawn with a initial patio area and pathway leading up to the end of the garden. There is also side access via a tunnel.

The property is located in a mature residential road to the west of Hertford town and within close proximity to Hertford North station and a handful local shops and amenities.



Ground Floor

Approx. 37.9 sq. metres (407.5 sq. feet)

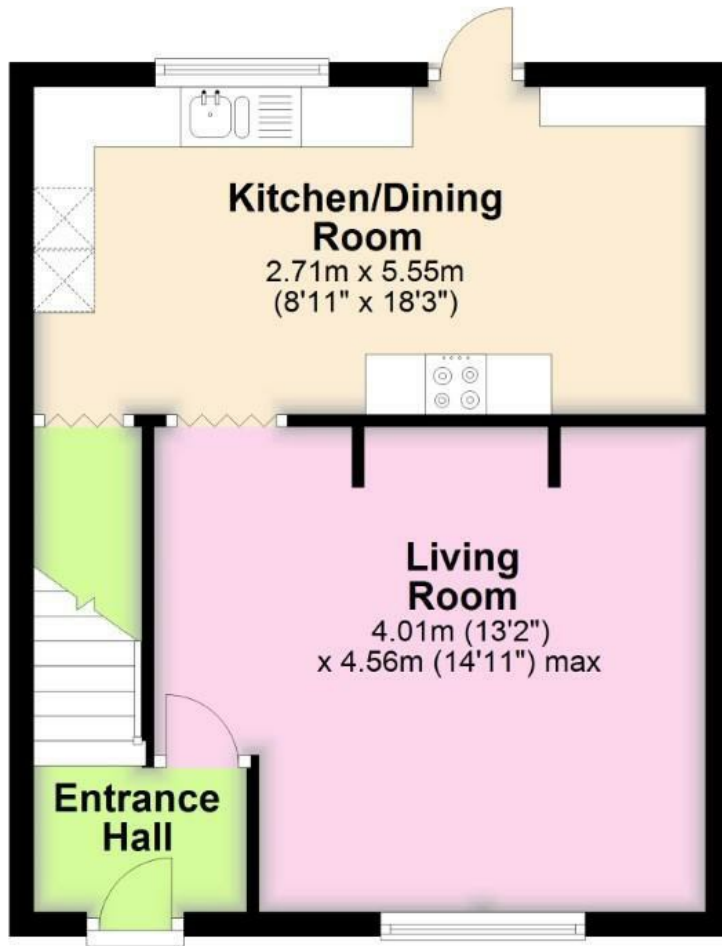

First Floor

Approx. 42.1 sq. metres (452.7 sq. feet)

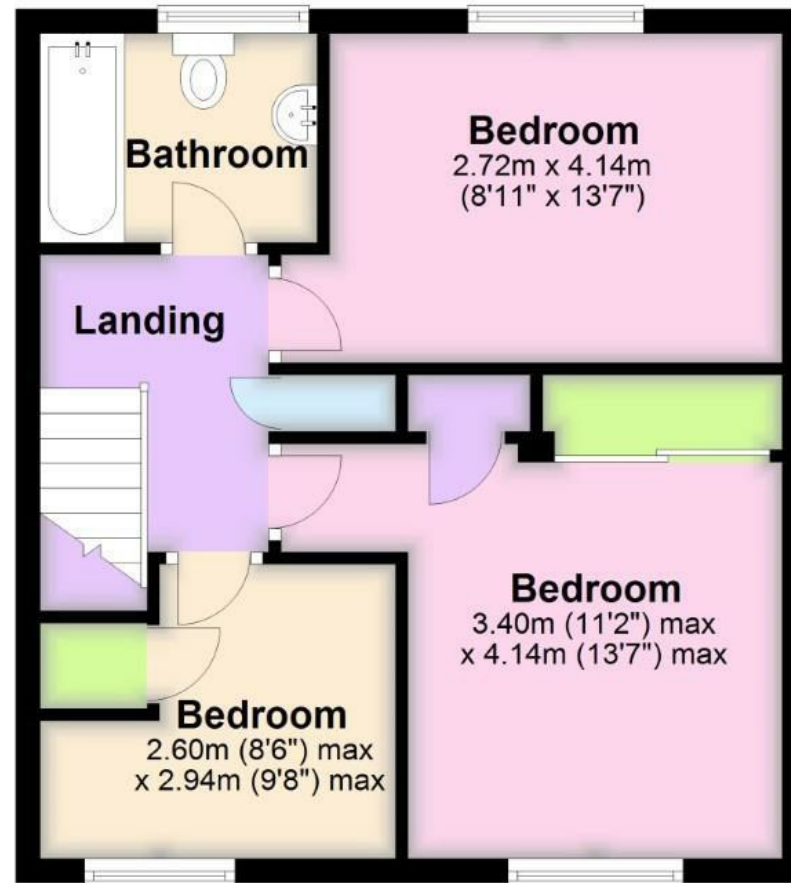

Total area: approx. 79.9 sq. metres (860.2 sq. feet)





SIMPLY HOMES

115 Fore Street | Hertford | SG14 1AS | 01992 558 557 | sales@simply-homes.co.uk | simply-homes.co.uk | Find us on

